

COLPAI Project Newsletter

www.colpai-project.co.uk

COLPAI Project

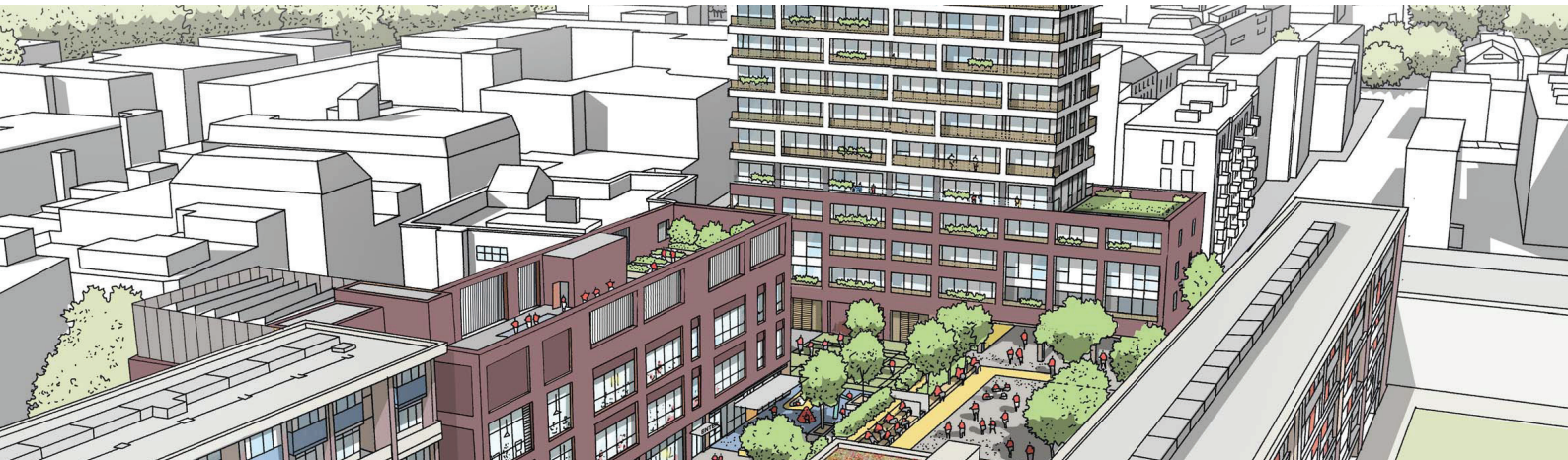

Dear Neighbour

We are writing to update you on the progress on-site at the COLPAI Project.

We have been progressing well with works on-site. The residential building is advancing and construction of level ten has now started. We expect this to be completed in the next couple of weeks. The fit-out of the educational buildings is well underway, including window, mechanical, electrical and plumbing (MEP), drywall installation and plastering. Works have taken place to the roof of the main school and sports hall. You can find some imagery of the progress on-site on page four of this newsletter.

Thank you to those who attended our online public webinar on Thursday 21 January 2021. Copies of all of the materials including a recording of the webinar, the presentation and notes are available on our project website www.colpai-project.co.uk in the 'downloads' section.

By way of an update, we have prepared a table to show the status of the remaining planning conditions to be discharged at the COLPAI Project. The table includes information for the planning conditions that have been submitted and are pending a decision, in addition to the planning conditions that are awaiting submission. A copy of the table can be found on page three of this newsletter.

WORKING HOURS

The consented working hours are:

Monday to Friday

8am to 6pm

Saturday

9am to 2pm

The consented reduced impact hours are:

Monday to Friday

10am to 12pm and 2pm to 4pm

KEY CONTACTS

For site emergencies, please contact:

Steven McCarthy, ISG

T: 07825 719 496

For general enquiries, please contact the project team:

E: info@colpai-project.co.uk

T: 0800 772 0475

For the Department of Community and Children's Services (DCCS), please contact:

Paul Murtagh

T: 0207 332 3015

COLPAI - Measured Noise, Vibration and Dust Levels - February 2021
Site Action Values - 73 dB LAeq 10 hour (Noise) 4 mm/s PPV (Vibration) and 190 µg/m³ (Dust)

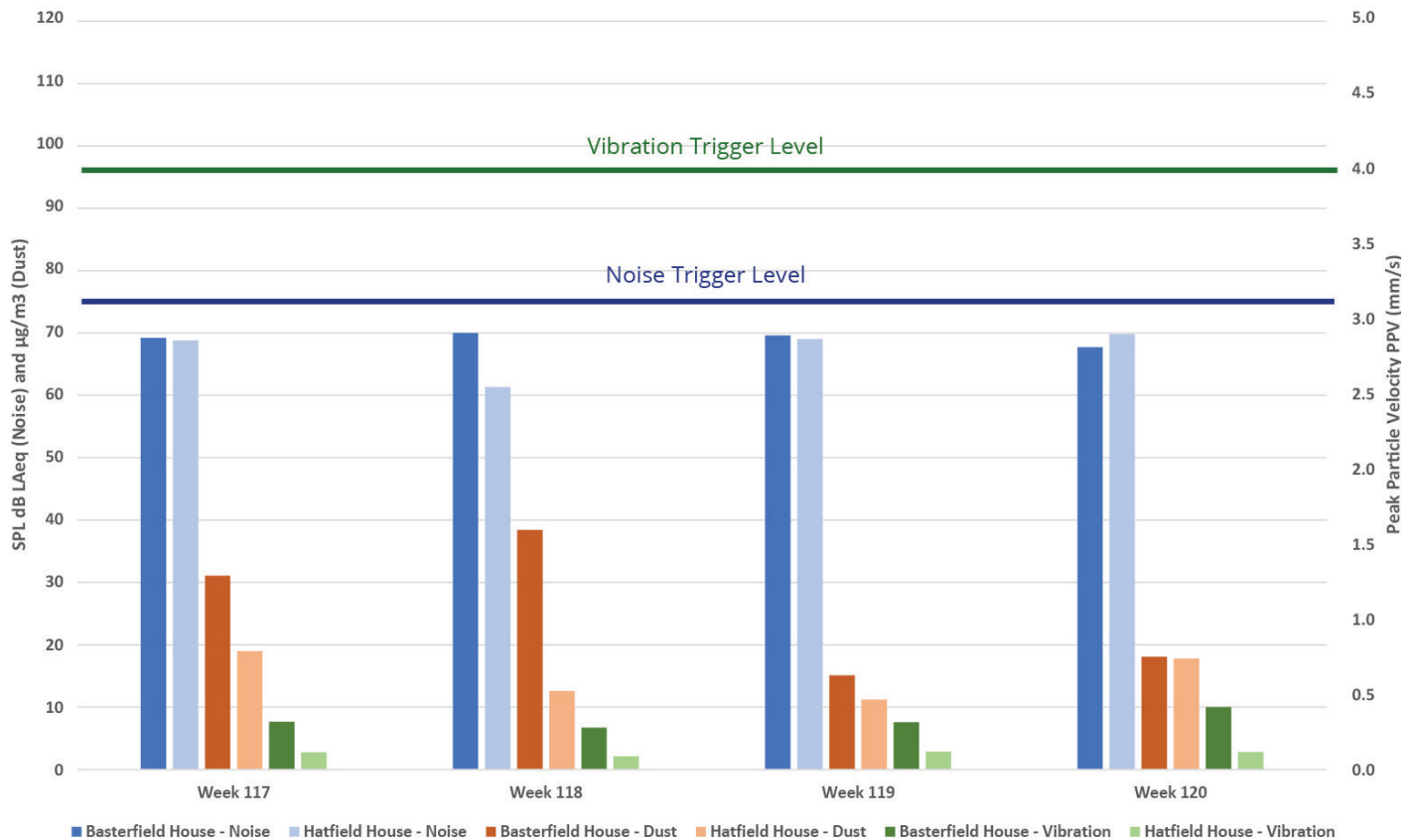

COLPAI PROJECT WEBINAR

On **Thursday 18 March 2021** at **7pm**, our next online public webinar is being held to provide an update of the works on-site and provide the local community with an opportunity to ask the project team questions.

Please visit the project website www.colpai-project.co.uk to register for the webinar. Alternatively, you can join the webinar via telephone by calling 0203 481 5237 and entering the webinar ID: 835 8160 6005.

Condition Number	Condition Title	Submission to	Submitted/ Awaiting Submission	Anticipated date for Determination	Application Reference Numbers
Whole Site					
Condition 26/27/28/ 36	Landscaping & Bird / Bat Boxes	COL & LBI	Submitted	Feb 2021	COL: 20/00742/MDC LBI: P2020/2631/AOD
Condition 38	Connection to enable discrete street lighting	COL & LBI	Awaiting submission	N/A	
Condition 41	Plant Noise	COL & LBI	Awaiting submission	N/A	
Condition 40	BREEAM	COL & LBI	Awaiting submission	N/A	
Condition 46	Collection of Rubbish	COL & LBI	Submitted	March 2021	COL: 20/00748/MDC LBI: P2020/2706/AOD
Condition 49	Land between existing building line and the face of the proposed new building	COL & LBI	Awaiting submission	N/A	
School Specific Conditions					
Condition 24d	School Doors	COL & LBI	Awaiting submission	N/A	
Condition 24j	Details of School entrance of Golden Lane	COL & LBI	Awaiting submission	N/A	
Condition 24k	Canopy Details	COL & LBI	Submitted	Feb 2021	COL: 20/00862/MDC LBI: P2020/3050/AOD
Condition 30	School Lighting	COL & LBI	Submitted	Feb 2021	COL: 20/00830/MDC LBI: P2020/2990/AOD
Condition 35	Kitchen Plant	COL & LBI	Submitted	Feb 2021	COL: 20/00735/MDC LBI: P2020/2416/AOD
Condition 42	Acoustic Barrier	COL & LBI	Submitted	Feb 2021	COL: 20/00829/MDC LBI: P2020/2991/AOD
Condition 43	Delivery and Servicing Plan	COL & LBI	Submitted	March 2021	COL: 20/00748/MDC LBI: P2020/2706/AOD
Condition 48	Fire Escape Strategy	COL & LBI	Awaiting submission	N/A	
Residential Specific Conditions					
Condition 25 a/b/c/e/ f/g/h/i/m	Facing Materials	COL & LBI	Submitted	Feb 2021	COL: 19/01279/MDC LBI: P2019/3682/AOD
Condition 25 j/l/k/n	Facing Materials	COL & LBI	Submitted	Feb 2021	COL: 20/00853/MDC LBI: P2020/3029/AOD
Condition 25d	Residential Doors	COL & LBI	Awaiting submission	N/A	
Condition 31	Residential Lighting	COL & LBI	Awaiting submission	N/A	
Condition 44	Delivery and Servicing Plan	COL & LBI	Submitted	March 2021	COL: 20/00747/MDC LBI: P2020/2679/AOD
Condition 47	Mobile Play Equipment	COL & LBI	Submitted	March 2021	COL: 20/00055/MDC LBI: P2020/0119/AOD

Note: Conditions shaded grey have been consulted on with the local community, as agreed.

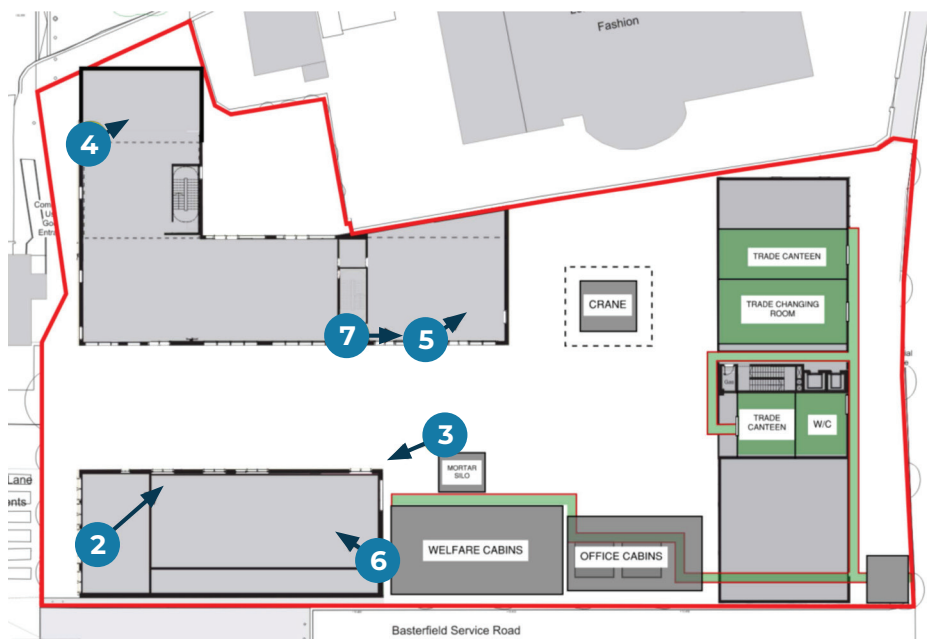

Map showing the COLPAI Project site



Residential Progress

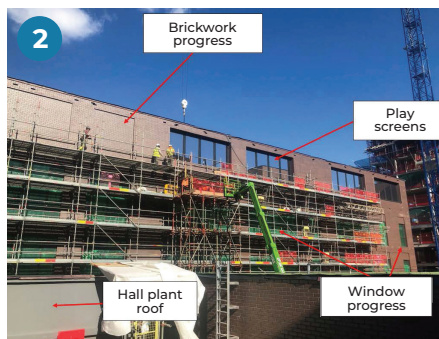

Main School Progress



Sports Hall Progress



Main School Plant Roof Screens



Main School Ground Floor MEP Progress



Sports Hall Internal Drylining and MEP Progress



Main School Painting, Joinery and MEP Progress

The works at the COLPAI Project are continuing in strict accordance with guidelines issued by the Government and Public Health England relating to COVID-19. ISG is progressing with works on-site and is working tirelessly to ensure the site operations go above and beyond the Government guidelines issued for construction sites. All contractors are aware of the standards they must uphold, and these are revisited daily at on-site briefings.

Best wishes

COLPAI Project Team