

COLPAI Project Newsletter

www.colpai-project.co.uk



Dear Neighbour

We are writing to update you on progress with construction works on-site at the COLPAI Project. Construction of the residential building is progressing well. Brickwork, drywall installation, screeding, mechanical, electrical and plumbing (MEP) installations are underway at all levels.

Progress photographs of the residential building are included on the last page of this newsletter.

COLPAI PROJECT WEBINAR

On **Wednesday 15 December 2021 at 7pm**, our next online public webinar is being held to provide an update of the works on-site and provide the local community with an opportunity to ask the project team questions. Please visit the project website **www.colpai-project.co.uk** to register for the webinar.

You can also join the webinar by telephone if it better suits your needs by calling **0203 901 7895**. The webinar ID is **824 8261 6800**.

WORKING HOURS

The consented working hours are:

Monday to Friday

- 8am-6pm
- 10am-12pm (quiet works)

Saturday

- 9am-2pm
- 2pm-4pm (quiet works)

The consented reduced impact hours are:

Monday to Friday

10am-12pm and 2pm-4pm

KEY CONTACTS

For site emergencies, please contact:

John Macleod, ISC

T: 07816 337 792

For general enquiries, please contact the project team:

E: info@colpai-project.co.uk

T: 0800 772 0475

For the Department of Community and Children's Services (DCCS), please contact:

Paul Murtagh

T: 0207 332 3015

PROJECT UPDATES

FACILITIES MANAGEMENT - EMAIL ADDRESS

We would also like to advise that the facilities management provider for the City of London Primary Academy Islington, Bouygues Energies and Services, has set up a designated email address to enhance its communications with the local community.

Moving forward, please contact **colatprimaryislington@bouygues-es.co.uk** directly with any school related queries. The email account will align with the 24/7 helpdesk service.

SCHOOL HALL MANAGEMENT PLAN

A Management Plan for the community use of the school hall has been submitted to The City of London and London Borough of Islington in relation to Planning Condition 64. The two planning authorities are presently seeking further information after which the documents will be updated if needed and we will inform stakeholders when the planning authorities post the document on their respective website for comments.

Construction activities for the COLPAI Project are continuing in strict accordance with guidelines issued by the Government and Public Health England relating to COVID-19. ISG is progressing with works on-site and is working tirelessly to ensure the site operations go above and beyond the Government guidelines issued for construction sites. All contractors are aware of the standards they must comply with and these are reviewed daily at on-site briefings.

Best wishes

COLPAI Project Team

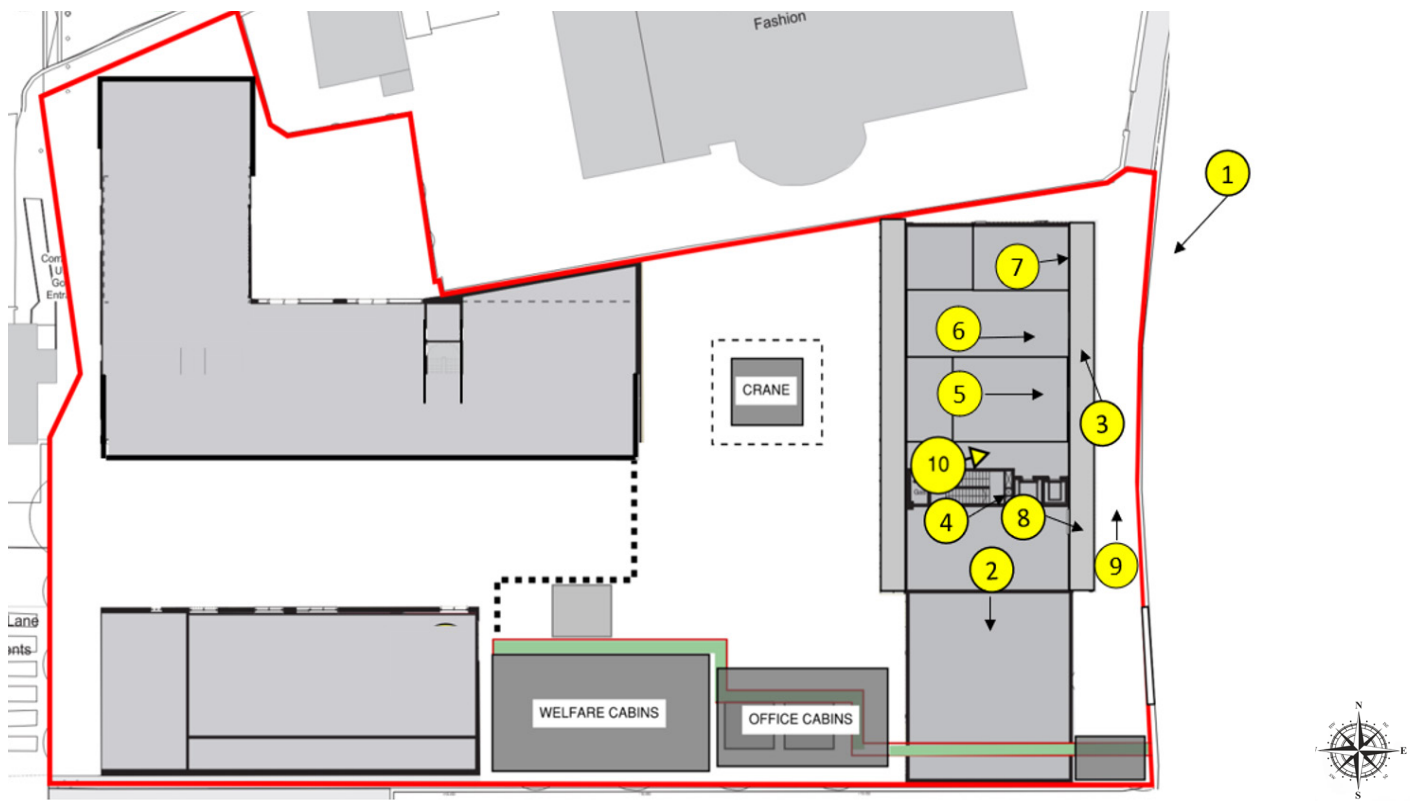

Site plan showing the COLPAI Project site in red with the key areas highlighted.

